



Aishwariya Meditech Pvt Ltd

B-1231, iThum Tower, Plot N- A-40. Sector 62, Noida 201301 U.P. www.aishmed.com



AISHWARIYA MEDITECH PVT LTD

WE ARE CERTIFIED BY: -



BMG
QUALITY CERTIFICATION

Certificate of Registration

*This is to certify that
The Quality Management System of*

AISHWARIYA MEDITECH PRIVATE LIMITED
12TH FLOOR, UNIT NO. 31, TOWER-B, ITHUM TOWER, A- 40,
SECTOR-62, NOIDA, GAUTAM BUDDHA NAGAR-201301,
UTTAR PRADESH, INDIA

*has been assessed and found to be in accordance with the
requirements of the management system standard*

ISO 9001:2015

for the following scope :

**DESIGN, SUPPLY AND INSTALLATION OF CENTRAL STERILE SUPPLY
DEPARTMENT, MODULAR OPERATION THEATRES AND MEDICAL
GAS PIPING SYSTEM**

CERTIFICATE No. : 20ZQCA1838Q

ISSUED DATE : 21/09/2020 1ST SURVEILLANCE : 20/08/2021
EXPIRY DATE : 20/09/2023 2ND SURVEILLANCE : 20/08/2022

UAF IS FULL MEMBER OF IAF

Managing Director

Accreditation No. - 51812480122
Accredited By United Accreditation Foundation (UAF)
3518, Colmar, Norfolk, Va 23509, United State of America (USA)

For BMG Conformity Assessment Services Pvt. Ltd.
C-3/8, 2nd Floor, Sector-10, Noida-201301, G.B. Nagar, (U.P.)
This Certificate is Intellectual Property of BMG and can be maintained through surveillance and renewal audit.
Certificate should be returned to BMG in case of non-compliance of certification procedure.
Authenticity & Status of this certificate can be verified at www.bmgcertification.com or <https://uafaccreditation.org>

भारत सरकार
Government of India
सूक्ष्म, लघु एवं मध्यम उद्यम मंत्रालय
Ministry of Micro, Small and Medium Enterprises

MSME
सूक्ष्म, लघु एवं मध्यम उद्यम
MINISTRY OF MICRO, SMALL & MEDIUM ENTERPRISES

UDYAM REGISTRATION CERTIFICATE

Our small hands to make you LARGE

TYPE OF ENTERPRISE	MICRO	MANUFACTURING																				
UDYAM REGISTRATION NUMBER	UDYAM-UP-28-000703																					
NAME OF ENTERPRISE	MS AISHWARIYA MEDITECH PRIVATE LIMITED																					
SOCIAL CATEGORY OF ENTREPRENEUR	General																					
NAME OF UNITS	<table border="1"> <tr> <th>SNo.</th> <th colspan="2">Units Name</th> </tr> <tr> <td>1</td> <td colspan="2">MS AISHWARIYA MEDITECH PRIVATE LIMITED</td> </tr> </table>		SNo.	Units Name		1	MS AISHWARIYA MEDITECH PRIVATE LIMITED															
SNo.	Units Name																					
1	MS AISHWARIYA MEDITECH PRIVATE LIMITED																					
OFFICIAL ADDRESS OF ENTERPRISE	<table border="1"> <tr> <th>Plot/Door Block No.</th> <th>8-221, 12TH FLOOR</th> <th>Name of Premises/ Building</th> <th>I THUM TOWER</th> </tr> <tr> <td>Village/Town</td> <td>PLOT NO-A-40</td> <td>Block</td> <td>BLOCK-B</td> </tr> <tr> <td>Road/Street/Lane</td> <td>SECTOR-62</td> <td>City</td> <td>NOIDA</td> </tr> <tr> <td>State</td> <td>UTTAR PRADESH</td> <td>District</td> <td>GAUTAM BUDDHA NAGAR, Pin 201301</td> </tr> <tr> <td>Mobile</td> <td>7991091090</td> <td>Email</td> <td>RAJY.MENHEG@GMAIL.COM</td> </tr> </table>		Plot/Door Block No.	8-221, 12TH FLOOR	Name of Premises/ Building	I THUM TOWER	Village/Town	PLOT NO-A-40	Block	BLOCK-B	Road/Street/Lane	SECTOR-62	City	NOIDA	State	UTTAR PRADESH	District	GAUTAM BUDDHA NAGAR, Pin 201301	Mobile	7991091090	Email	RAJY.MENHEG@GMAIL.COM
Plot/Door Block No.	8-221, 12TH FLOOR	Name of Premises/ Building	I THUM TOWER																			
Village/Town	PLOT NO-A-40	Block	BLOCK-B																			
Road/Street/Lane	SECTOR-62	City	NOIDA																			
State	UTTAR PRADESH	District	GAUTAM BUDDHA NAGAR, Pin 201301																			
Mobile	7991091090	Email	RAJY.MENHEG@GMAIL.COM																			
DATE OF INCORPORATION / REGISTRATION OF ENTERPRISE	28/05/2020																					
DATE OF COMMENCEMENT OF PRODUCTION/BUSINESS	01/09/2020																					
NATIONAL INDUSTRY CLASSIFICATION CODE(S)	<table border="1"> <tr> <th>SNo.</th> <th>NIC 2 Digit</th> <th>NIC 4 Digit</th> <th>NIC 5 Digit</th> <th>Activity</th> </tr> <tr> <td>1</td> <td>32 - Other manufacturing</td> <td>3250 - Manufacture of medical and dental instruments and supplies</td> <td>32509 - Manufacture of other medical and dental instruments n.e.c.</td> <td>Manufacturing</td> </tr> <tr> <td>2</td> <td>71 - Architecture and engineering activities, technical testing and analysis</td> <td>7110 - Architectural and engineering activities and related technical consultancy</td> <td>71100 - Architectural and engineering activities and related technical consultancy</td> <td>Services</td> </tr> </table>		SNo.	NIC 2 Digit	NIC 4 Digit	NIC 5 Digit	Activity	1	32 - Other manufacturing	3250 - Manufacture of medical and dental instruments and supplies	32509 - Manufacture of other medical and dental instruments n.e.c.	Manufacturing	2	71 - Architecture and engineering activities, technical testing and analysis	7110 - Architectural and engineering activities and related technical consultancy	71100 - Architectural and engineering activities and related technical consultancy	Services					
SNo.	NIC 2 Digit	NIC 4 Digit	NIC 5 Digit	Activity																		
1	32 - Other manufacturing	3250 - Manufacture of medical and dental instruments and supplies	32509 - Manufacture of other medical and dental instruments n.e.c.	Manufacturing																		
2	71 - Architecture and engineering activities, technical testing and analysis	7110 - Architectural and engineering activities and related technical consultancy	71100 - Architectural and engineering activities and related technical consultancy	Services																		
DATE OF UDYAM REGISTRATION	14/09/2020																					

Disclaimer: This is computer generated statement, no signature required.
Printed from <https://udyamregistration.gov.in>

For any assistance, you may contact:

1. DIC GAUTAM BUDDHA NAGAR
2. MSME-DI DELHI

Visit : www.msme.gov.in ; www.dcmsme.gov.in ; www.champions.gov.in

Follow us @minmsme & @msmechampions

BE A CHAMPION with the Ministry of MSME

UK
QUALITY CERTIFICATION

UKAC
UK
ACCREDITING
CERTIFICATION
LIMITED

Certificate of Registration

*This is to certify that The Quality
Management System of Medical Devices*

AISHWARIYA MEDITECH PRIVATE LIMITED
12TH FLOOR, UNIT NO. 31, TOWER-B, ITHUM TOWER, A- 40,
SECTOR-62, NOIDA, GAUTAM BUDDHA NAGAR-201301,
UTTAR PRADESH, INDIA

*has been assessed and found to be in compliance
with the requirements of the standard*

ISO 13485:2016

for the following scope :

**DESIGN, SUPPLY AND INSTALLATION OF CENTRAL STERILE SUPPLY
DEPARTMENT, MODULAR OPERATION THEATRES AND MEDICAL
GAS PIPING SYSTEM**

CERTIFICATE No. : 20ZQCA6370M

ISSUED DATE : 21/09/2020 1ST SURVEILLANCE : 20/09/2021
EXPIRY DATE : 20/09/2023 2ND SURVEILLANCE : 20/09/2022

Authorised Signatory
INTERNATIONAL QUALITY CERTIFICATION SERVICES UK LTD
272, Bath Street, Glasgow, G2 4JR, U.K.

This Certificate is Intellectual Property of IQCS and can be maintained through surveillance and renewal audit.
Certificate should be returned to IQCS in case of non-compliance of certification procedure.
Authenticity of this certificate can be verified at www.iqcs.co.uk / www.ukcert.co.uk
The Registration is not a Product Quality Certificate.

FIXED SURGICAL PENDANT

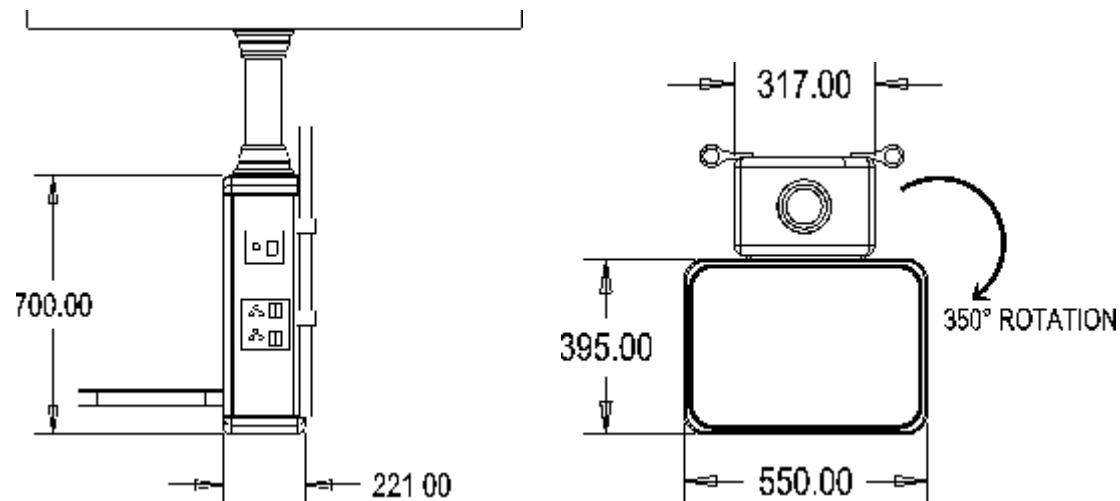

Installation Space: High movement and space to operate. Ceiling mounted is rotatable around its horizontal axis up to 350 degree.

Technical Specifications:

Product Code	: ALT 601
Product Name	: Fixed Surgical pendant
Carriage Capacity	: Max 120 Kg
Gas Equipment	: Variable according to project
Electrical Equipment	: 6 X Electric Sockets, (optional)
Operating Temperature	: (+10) - (+45) C°
Power Supply	: 220 V 50 Hz
Packaging Type	: Wrapped Package /wooden packing with extra charge .
Package Sizes	: 800 x 620 x 700 mm & 1070x140x260 mm & size of upper ceiling Mounting part
Product Weight	: 120Kg
Product Main Raw Material	: Aluminum Extrusion Profile and high impactive ABS With SS304 Screws
IV Stand	: Two Pole with Hangers
Color	: Single /Dual color combination or as per requirement
Trays	: 2 (adjustable)

Accessories:

Gas outlets, instrument basket, vacuum carrier. Monitor Stand/Drawer/Trays.



SINGLE ARM SURGICAL PENDANT

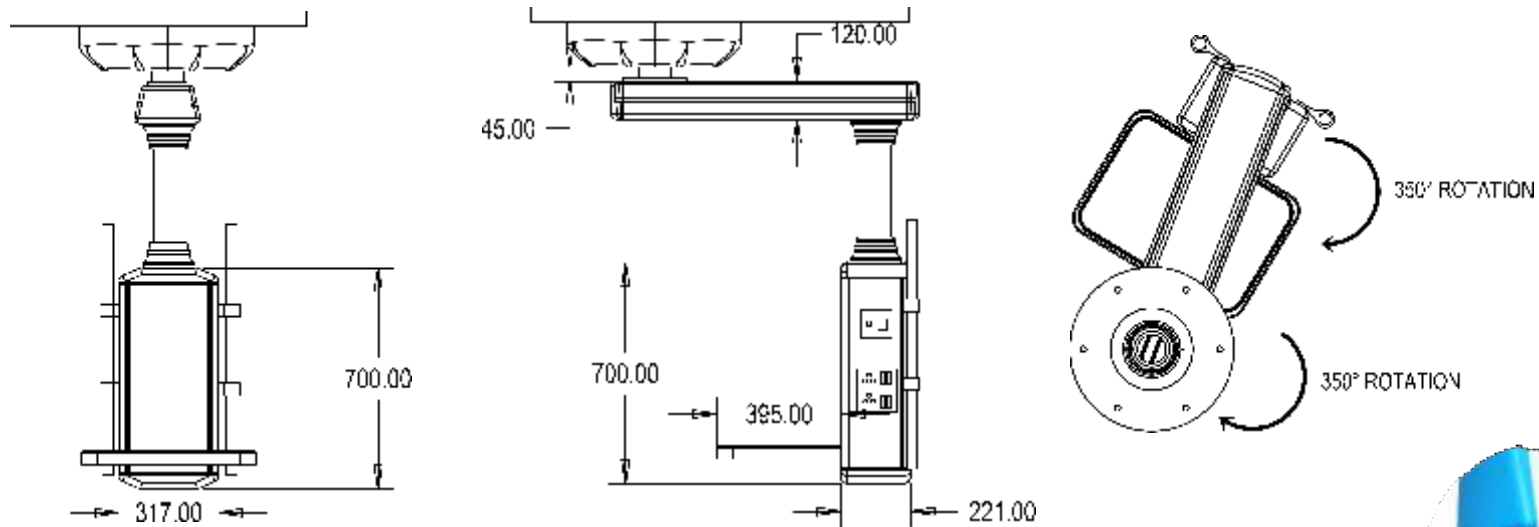

Installation Space: High movement and space to operate. Ceiling mounted and extension arm is rotatable around its horizontal axis up to 350 degree.

Technical Specifications:

Product Code	: AMT 602
Product Name	: Single Arm Surgical Pendant- Standard
Carriage Capacity	: Max 120 Kg
Gas Equipment	: Variable according to project
Electrical Equipment	: 6 X Electric Sockets, (optional)
Operating Temperature	: (+10) - (+45) C°
Power Supply	: 220 V 50 Hz
Horizontal Arm Length	: 600mm to 1000 mm
Packaging Type	: Wrapped Package /wooden packing with extra charge.
Package Sizes	: 800 x 620 x 700 mm & 1070x140x260 mm & size of upper ceiling Mounting part
Product Weight	: 120Kg
Product Main Raw Material	: Aluminum Extrusion Profile and high impactive ABS With SS304 Screws
IV Stand	: Two Pole with Hangers
Color	: Single /Dual color combination or as per requirement
Trays	: 2 (adjustable)

Accessories:

Gas outlets, instrument basket, vacuum carrier. Monitor Stand/Drawer/Trays.



DOUBLE ARM SURGICAL PENDANT:

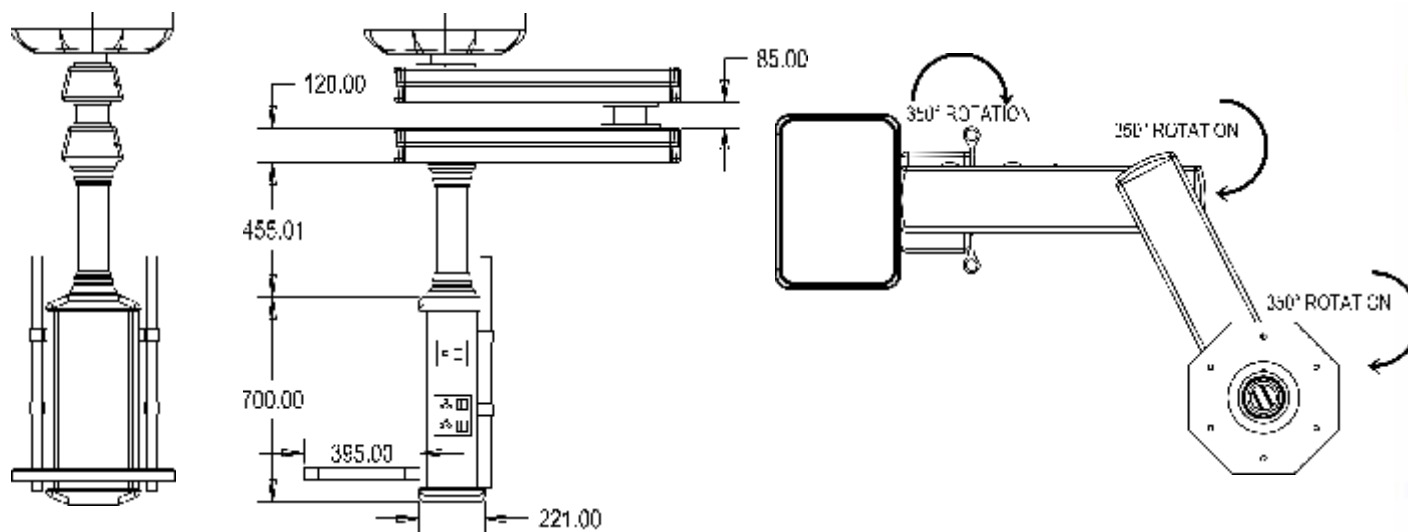

Installation Space: High movement and space to operate. 3 Joints and double extension arm is rotatable around its horizontal axis up to 350 degree.

SPECIFICATIONS

Product Code	: AMT 603
Product Name	: Double Arm Surgical Pendant
Carriage Capacity	: Max 100 Kg
Gas Equipment	: Variable according to project
Electrical Equipment	: 6 X Electric Sockets, (optional)
Operating Temperature	: (+10) - (+45) C°
Power Supply	: 220 V 50 Hz
Horizontal Arm Length	: 2x 600 to 1000 mm
Packaging Type	: Wrapped Package / wooden packing with extra charge.
Product Weight	: 152Kg
Product Main Raw Material	: Aluminum Extrusion Profile high impactive ABS With SS304 Screws
IV Stand	: Two Pole with Hangers
Color	: Single / Dual color combination or as per requirement
Trays	: 2 (adjustable)

Accessories:

Gas outlets, instrument basket, vacuum carrier. Monitor Stand/Drawer/Trays.



FIXED LAPAROSCOPIC / ANESTHETIC PENDANT

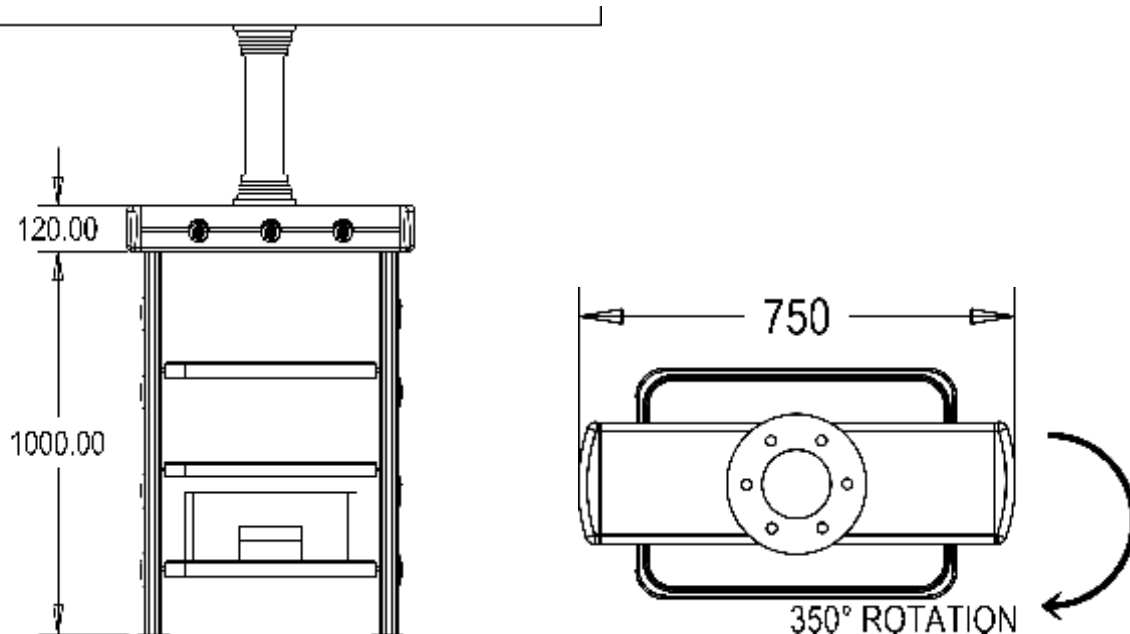

Installation Space: Mounted on the ceiling by straight connection support and rotatable around its vertical axis up to 350 degree.

Technical Specifications

Product Code	: AMT-604
Product Name	: Fixed laparoscopic pendant/Anesthetic pendant
Carriage Capacity	: Max 120 Kg
Gas Equipment	: Variable according to project(up to 5 gas outlet only)
Electrical Equipment	: 6X Electric Sockets, (optional)
Operating Temperature	: (+10) - (+45) C°
Power Supply	: 220 V 50 Hz
Packaging Type	: Wrapped Package /wooden packing with extra charge.
Package Sizes	: 1520 x 780 x 510 mm & Size of upper ceiling Mounting part
Product Weight	: 80 Kg
Product Main Raw Material	: Aluminum Extrusion Profile with high impactive ABS With SS304 Screws
Color	: Single /Dual color combination or as per requirement
Trays	: 2 (adjustable)

Accessories:

Gas outlets, instrument basket, vacuum carrier. Monitor Stand/Drawer/Trays.

SINGLE ARM LAPAROSCOPIC/ANESTHETIC PENDANT

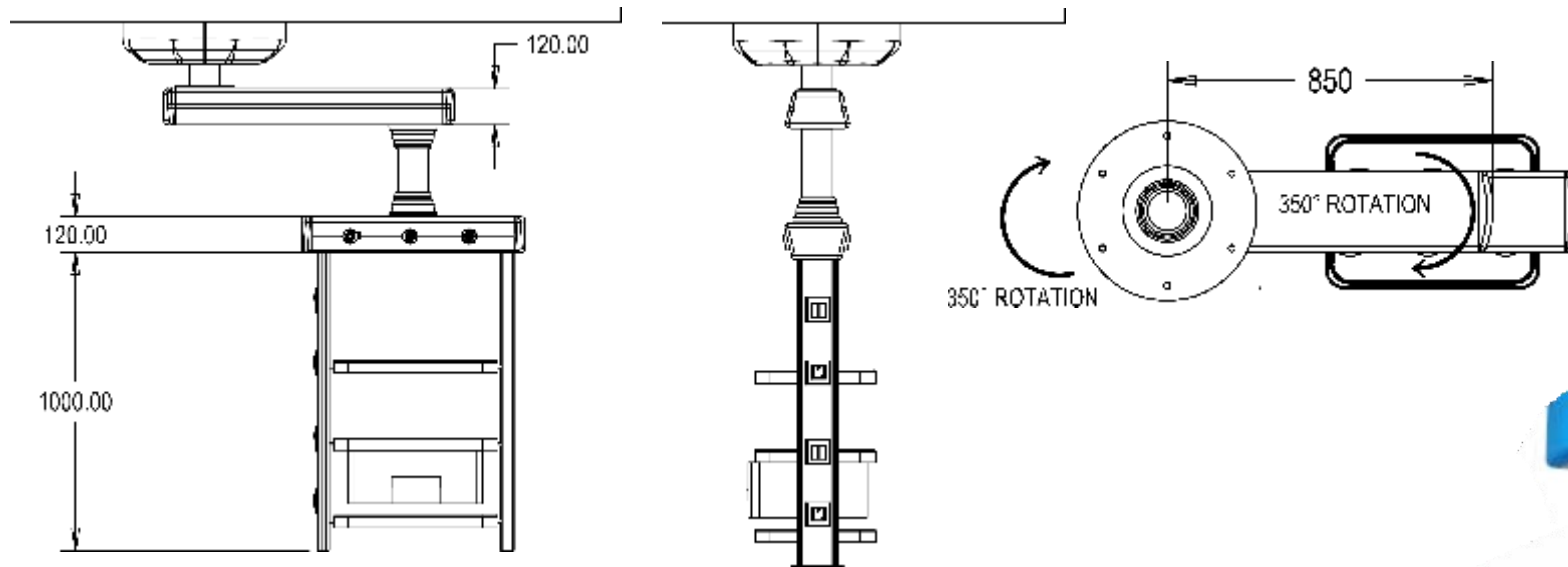

Installation Space: Mounted on the ceiling by straight connection support and rotatable around its vertical axis up to 350 degree.

Technical Specifications:

Product Code	: AMT-605
Product Name	: Single Arm laparoscopic / Anesthetic Pendant
Carriage Capacity	: Max 120 Kg
Vertical Movement	: 650 mm
Gas Equipment	: Variable according to project
Electrical Equipment	: 6 X Electric Sockets (optional)
Operating Temperature	: (+10) - (+45) C°
Power Supply	: 220 V 50 Hz
Horizontal Arm Length	: 800-1000 mm
Packaging Type	: Wrapped Package /wooden packing with extra charge.
Package Sizes	: 1520 x 780 x 510 mm & 1120x140x260 mm & Size of upper ceiling Mounting part
Product Weight	: 132Kg
Product Main Raw Material	: Aluminum Extrusion Profile high impactive ABS With SS304 Screws
Color	: Single /Dual color combination or as per requirement
Trays	: 2 (adjustable)

Accessories:

Gas outlets, instrument basket, vacuum carrier. Monitor Stand/Drawer/Trays.



DOUBLE ARM LAPAROSCOPIC / ANESTHETIC PENDANT

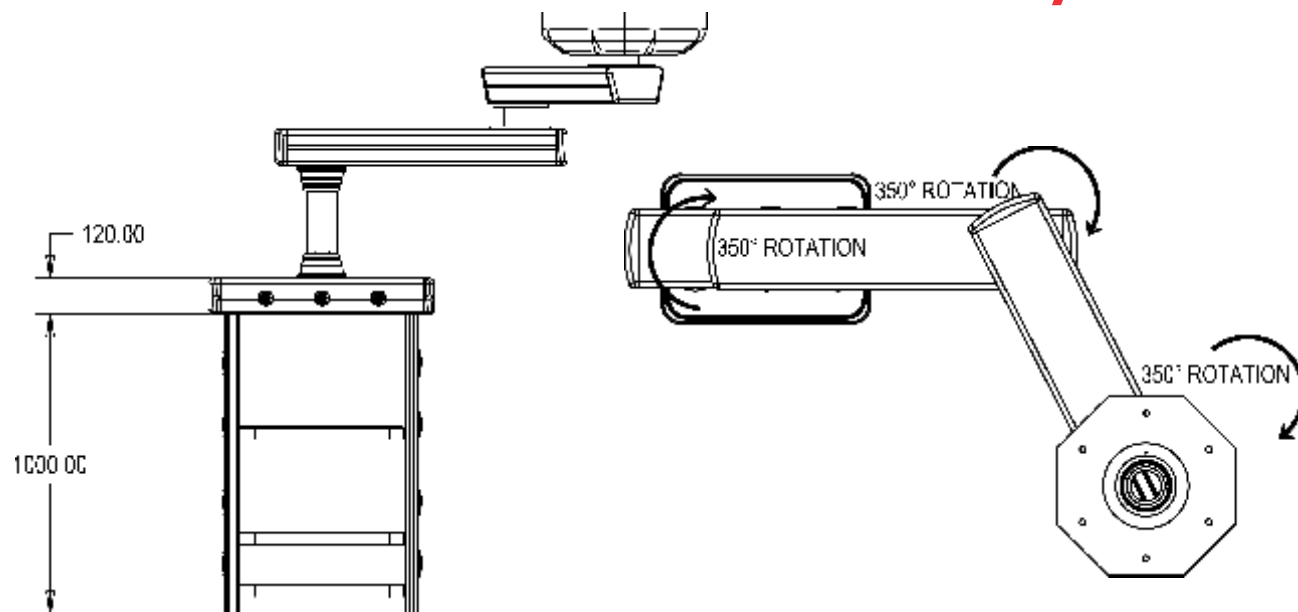

Installation Space: Mounted on the ceiling by straight connection support and rotatable around its vertical axis up to 350 degree.

Technical Specifications

Product Code	: AMT -606
Product Name	: Double Arm laparoscopic / Anesthetic Pendant
Carriage Capacity	: Max 100 Kg
Vertical Movement	: 650 mm
Gas Equipment	: Variable according to project
Electrical Equipment	: 8 X Electric Sockets, 4 X Electric Sockets (optional)
Operating Temperature	: (+10) - (+45) C°
Power Supply	: 220 V 50 Hz
Horizontal Arm Length	: 2 x 800-1000 mm
Packaging Type	: Wrapped Package /wooden packing with extra charge.
Package Sizes	: 1520 x 780 x 510 mm & 1120x140x260mm& 1070x140x260mm & Size of upper ceiling Mounting part
Product Weight	: 163Kg
Product Main Raw Material	: Aluminum Extrusion Profile high impactive ABS With SS304 Screws
Color	: Single /Dual color combination or as per requirement
Trays	: 2 (adjustable)

Accessories:

Gas outlets, instrument basket, vacuum carrier. Monitor Stand/Drawer/Trays.



MODULER FIXED PENDENT

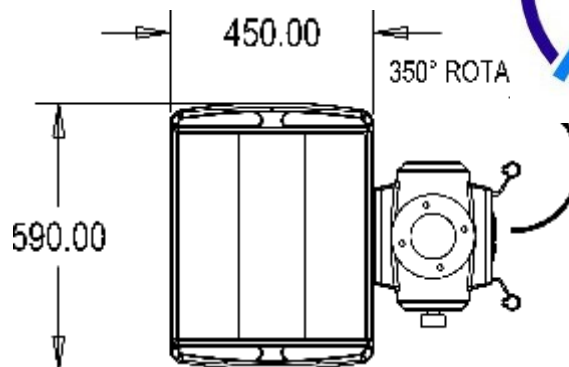
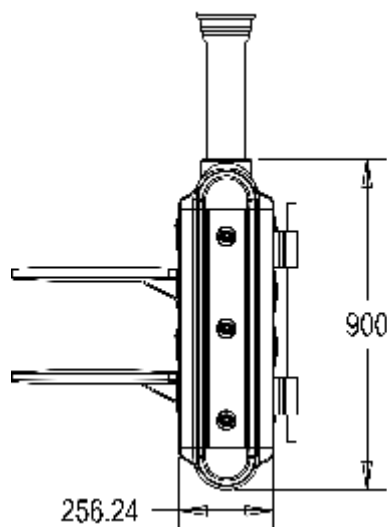

Installation Space: High movement and space to operate. Ceiling mounted and extension arm is rotatable around its horizontal axis up to 350 degree.

Technical Specifications:

Product Code	: AMT -607
Product Name	: Fixed Surgical pendant
Carriage Capacity	: Max 120 Kg
Gas Equipment	: Variable according to project
Electrical Equipment	: 6 X Electric Sockets, (optional)
Operating Temperature	: (+10) - (+45) C°
Power Supply	: 220 V 50 Hz
Horizontal Arm Length	: 800-1000 mm
Packaging Type	: Wrapped Package /wooden packing with extra charge.
Package Sizes	: 800 x 620 x 700 mm & 1070x140x260 mm & size of upper ceiling Mounting part
Product Weight	: 120Kg
Product Main Raw Material	: Aluminum Extrusion Profile With high impactive ABS With SS304 Screws
Color	: Single /Dual color combination or as per requirement
IV Stand	: 2 Pole with Hangers
Trays	: 2 (adjustable)

Accessories:

Gas outlets, instrument basket, vacuum carrier. Monitor Stand/Drawer/Trays.



MODULER SINGLE ARM PENDENT

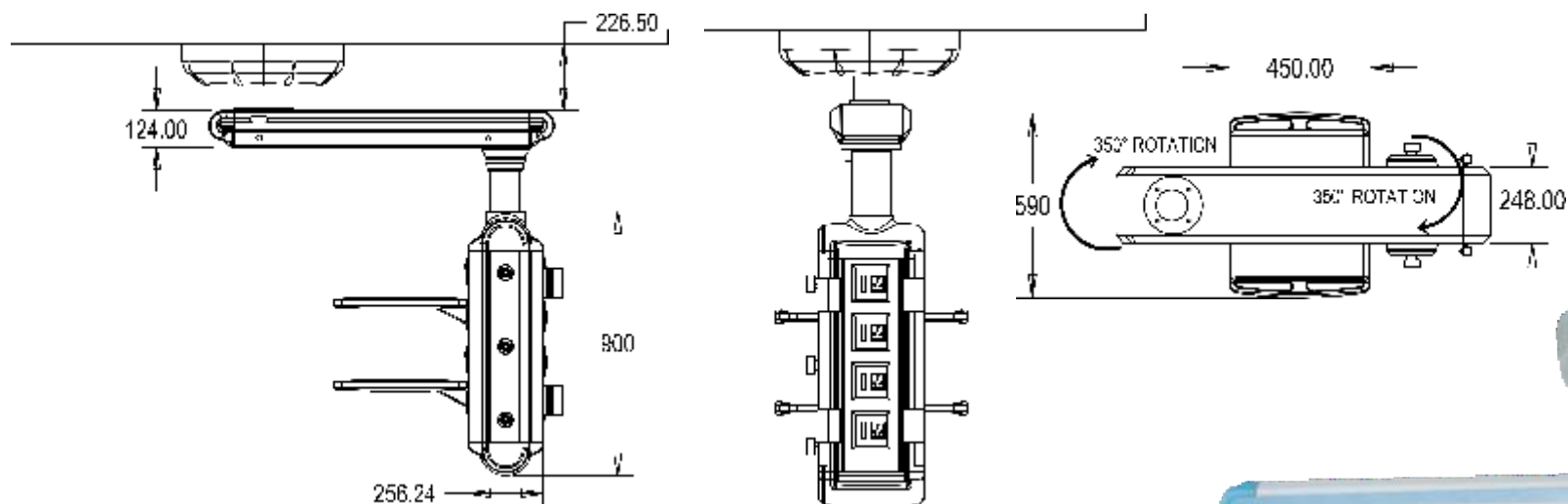

Installation Space: High movement and space to operate. Ceiling mounted and extension arm is rotatable around its horizontal axis up to 350 degree.

Technical Specifications:

Product Code	: AMT- 608
Product Name	: Single Arm Pendant- Standard
Number of Joints	2
Carriage Capacity	: Max 180 Kg
Gas Equipment	: Variable according to project
Electrical Equipment	: 8 X Electric Sockets (optional)
Operating Temperature	: (+10) - (+45) C°
Power Supply	: 220 V 50 Hz
Horizontal Arm Length	: 600-1200 mm
Packaging Type	: Wrapped Package /wooden packing with extra charge.
Package Sizes	: 800 x 620 x 700 mm & 1070x140x260 mm & size of upper ceiling Mounting part
Product Weight	:120Kg
Product Main Raw Material	: Aluminum Extrusion Profile high impactive ABS With SS304 Screws
Color	: Single /Dual color combination or as per requirement
Bricking System	: pneumatic brake/ Electric Brake optional
Trays	: 2 (adjustable)



Accessories:

Gas outlets, instrument basket, vacuum carrier. Monitor arm (optional) Breaking System.

MODULAR DOUBLE ARM PENDENT

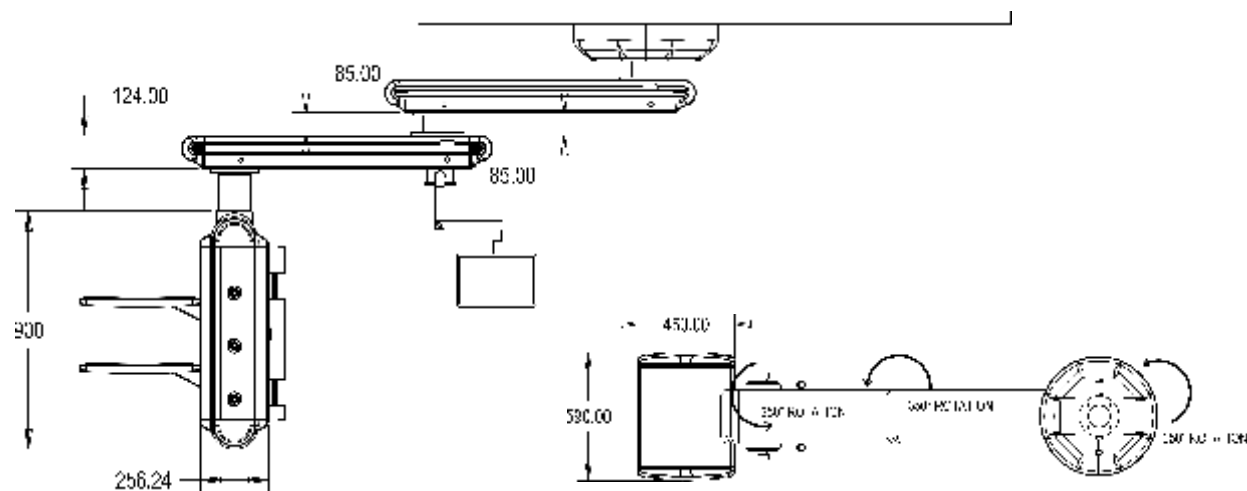

Installation Space: Mounted on the ceiling by straight connection support and rotatable around its vertical axis up to 350 degree.

Technical Specifications

Product Code	: AMT - 609
Product Name	: MODULAR DOUBLE ARM PENDENT
Carriage Capacity	: Max 120 Kg
Vertical Movement	: 650 mm
Gas Equipment	: Variable according to project
Electrical Equipment	: 6 X Electric Sockets, (optional)
Operating Temperature	: (+10) - (+45) C°
Power Supply	: 220 V 50 Hz
Horizontal Arm Length	: 2 x 800-1000 mm
Packaging Type	: Wrapped Package /wooden packing with extra charge.
Package Sizes	: 800 x 620 x 700 mm & 1120x140x260 mm& 1070x140x260 mm & Size of upper ceiling Mounting part
Product Weight	: 180Kg
Product Main Raw Material	: Aluminum Extrusion Profile high Impactive ABS With SS304 Screws
Color	: Dual color combination or as per requirement
Monitor Arm	: optional
Trays	: 2 (adjustable)

Accessories:

Gas outlets, Instrument basket, Vacuum carrier, breaking system.



MODULAR ELECTRIC SINGLE ARM PANDANT

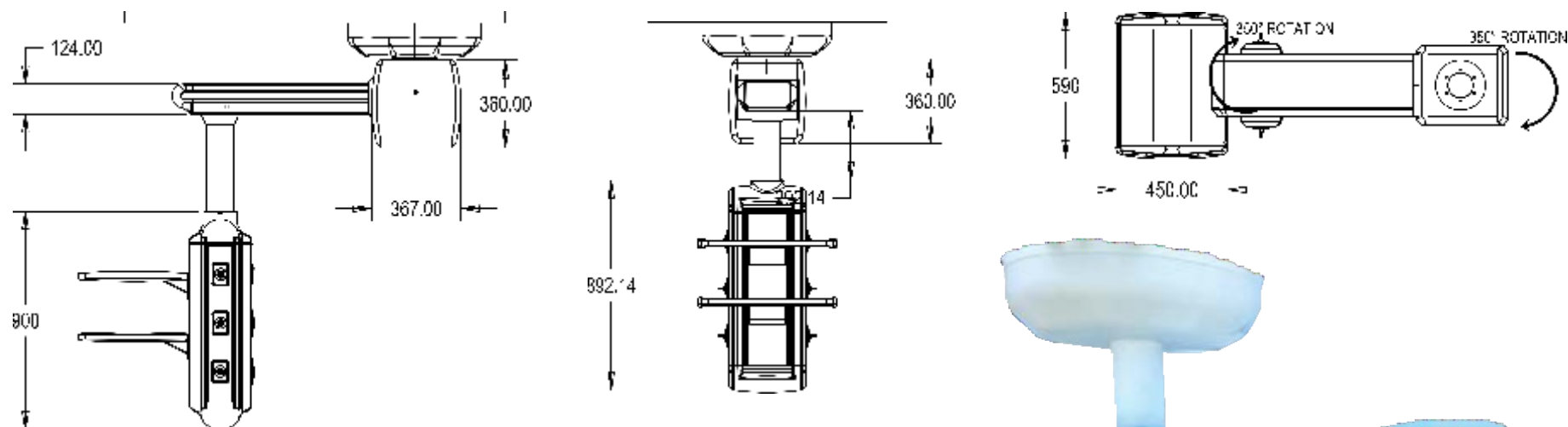

Installation Space: Mounted on the ceiling by straight connection support and rotatable around its vertical axis up to 350 degree.

Technical Specifications

Product Code	: AMT- 610
Product Name	: MODULAR ELECTRIC SINGLE ARM PANDANT
Carriage Capacity	: Max 150 Kg
Vertical Movement	: 650 mm
Gas Equipment	: Variable according to project
Electrical Equipment	: 6 X Electric Sockets, (optional)
Operating Temperature	: (+10) - (+45) C°
Power Supply	: 220 V 50 Hz
Horizontal Arm Length	: 80-100 cm
Packaging Type	: Wrapped Package /wooden packing with extra charge.
Package Sizes	: 1150 x 620 x 700 mm & 1120x140x260 mm & Size of upper ceiling Mounting part
Product Weight	: 180Kg
Product Main Raw Material	: Aluminum Extrusion Profile high impactive ABS With SS304 Screws
Color	: Single /Dual color combination or as per requirement
Trays	: 2 (adjustable)

Accessories:

Gas outlets, Instrument basket, Vacuum carrier Breaking System.



MODULAR ELECTRIC DOUBLE ARM PENDANT

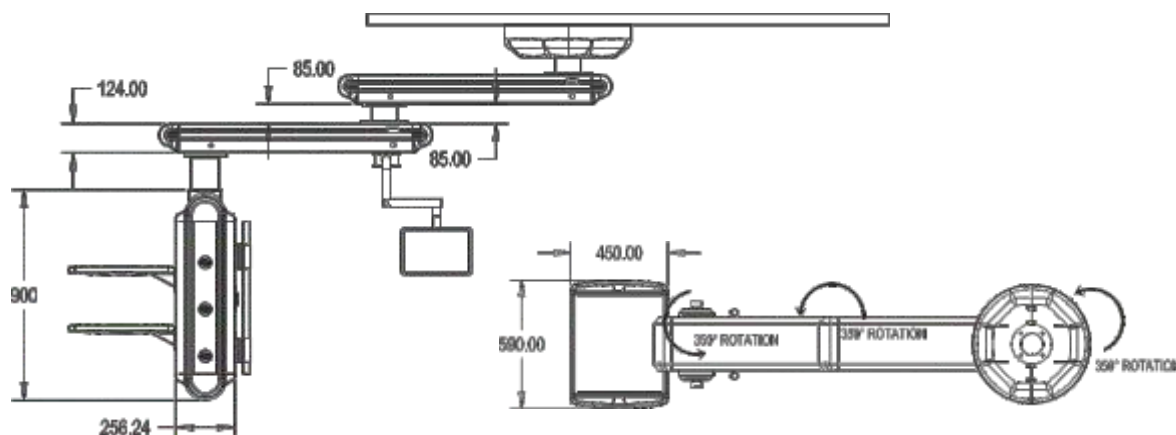

Installation Space: Mounted on the ceiling by straight connection support and rotatable around its vertical axis up to 350 degree. The double arm pendant is a height adjustable motor arm. Owing to its moveable axes and its height and adjustability offers an optimal horizontal and vertical movement.

Technical Specifications

Product Code	: AMT -611
Product Name	: Modular Electric Double arm Pendant
Carriage Capacity	: Max 120 Kg
Vertical Movement	: 650 mm
Gas Equipment	: Variable according to project
Electrical Equipment	: 6 X Electric Sockets, (optional)
Operating Temperature	: (+10) - (+45) C°
Power Supply	: 220 V 50 Hz
Horizontal Arm Length	: 80-100 cm
Packaging Type	: Wrapped Package /wooden packing with extra charge.
Package Sizes	: 1150 x 620 x 700 mm & 1120x140x260 mm & Size of upper ceiling Mounting part
Product Weight	: 210Kg & Upper ceiling connection part
Product Main Raw Material	: Aluminum Extrusion Profile with high impactive ABS With SS304 Screws
Configured Movement	: with pneumatic brake : 21 degrees up and 24 degrees down
Color	: Single /Dual color combination or as per requirement
Trays	: 2 to 5 (adjustable)

Accessories:

Gas outlets, Instrument basket, Vacuum carrier



GAS OUTLET AMT-

Each gas-specific front part contains the following components:

- Actuator
- Cartridge
- Gas-specific socket unit
- Warning label (not ready for operation)

CONSTRUCTION

Machined brass and zinc die-casting with stainless steel rolling pins

SPECIFICATIONS

1. Medical Gas Outlet Oxygen Outlet
2. O₂/Air/N₂O/Vacuum/CO₂/N₂/AGSS
3. Have past 100% gas tightness test
4. Material: copper

Gas type: O₂, VAC, AIR, N₂, N₂O, CO₂, AGSS and so on.

The body of material is Brass and sealing ring use medical silicone rubber.

Installation: Wall concealed installation; medical bridge pendant installation; bed head unit installation and so on

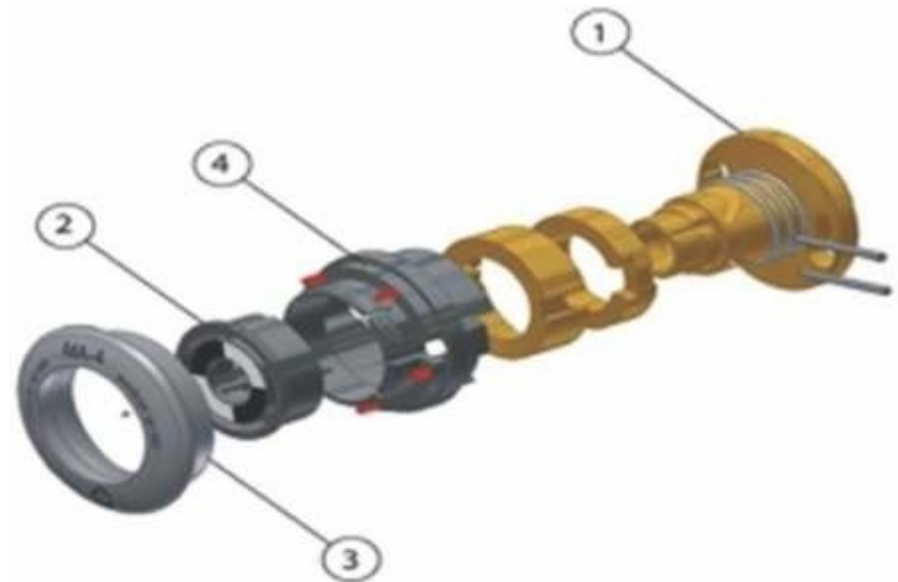

BED HEAD PANEL AMT-

SPECIFICATION:

- Powder coated aluminum body
- Electrical and wiring panels
- Gas outlet front panels
- UPS outlet
- Power outlet

Glass bed head panel



GAS ALARM SYSTEMS AMT-



Analog Gas Alarm Systems come in 1, 2, 3, 4, 5, and 6 gas categories where the number indicates the number of gases the system can handle. The system contains analog meters for displaying pressure of the different gases coming from the pipe lines. The system generates appropriate alarm in case of High pressure or Low Pressure in any gas. The alarm is shown on the Master Alarm System which is placed with the Administration.

Analog Gas Alarm Systems

ZONE VALVES & VALVE BOXES AMT-639

Valve Design

Our fully ported brass valves feature three-piece construction, double seals and quarter turn-to-off.

1. Able to 6 Valve
2. Each - each valve in Special design according to standard medical gas
3. Easy maintenance and replacement
4. Standard UL, CSA, ISO and NFPA 99
5. Equipped nameplate of each gas

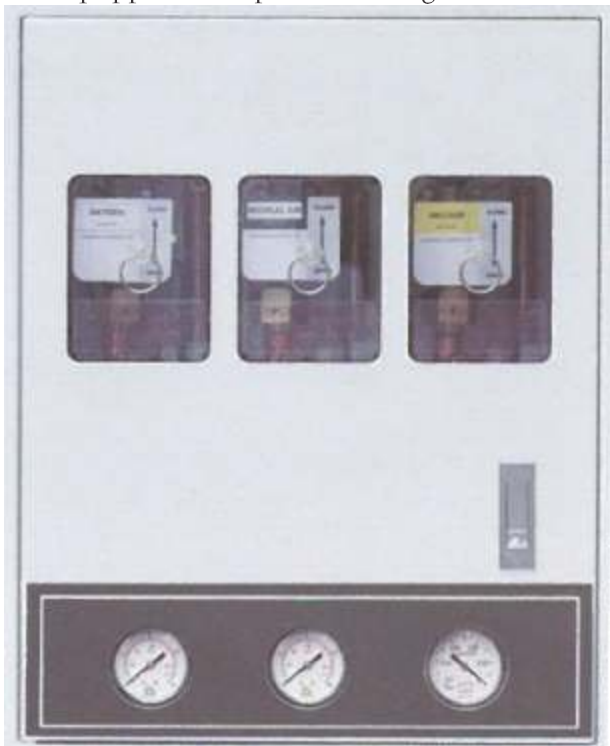

AREA VALVE SERVICE UNIT:

Characteristics

- Product applications: for medical gas plant



PRESSURE CONTROL PANEL

Every Operating Room need at least one Nitrogen Control Panel. The purpose of this panel is to regulate the Nitrogen Pressure from LINE (160-180) psi to what the user requires. Most pneumatic tools used in the OR, require 50-150 psi to operate.



WALL GARD AMT-



Product Features

Width	150mm
Offset	21mm
Max Lengths	12 feet
Corner conditions	continuous outside



Product Features

Width	150mm
Offset	21mm
Max Lengths	12 feet
Corner conditions	continuous outside



Product Features

Width	100mm
Offset	21mm
Max Lengths	12 feet
Corner conditions	continuous outside



Product Features

Height	157mm
Rail offset	76mm
Max Lengths	12 feet
Bracket type	Standard wall pro bracket
Corner conditions	continuous outside



CORNER GARD AMT-640(C)



Product Features

Width	76x76mm
Offset	21mm
Max Lengths	12 feet
Corner conditions	continuous outside



Width	52x52mm
Offset	9mm
Max Lengths	12 feet
Corner conditions	continuous outside



WALL AND CEILING PANEL AMT-

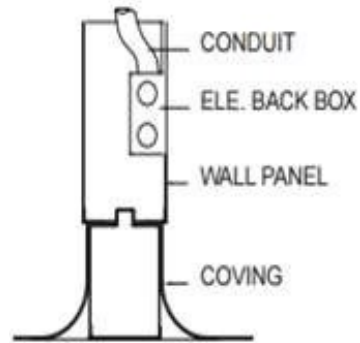

BASE DETAIL

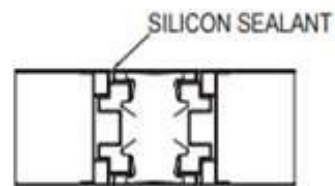

PANEL CONNECTOR

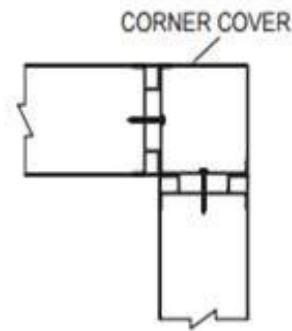

CORNER DETAIL

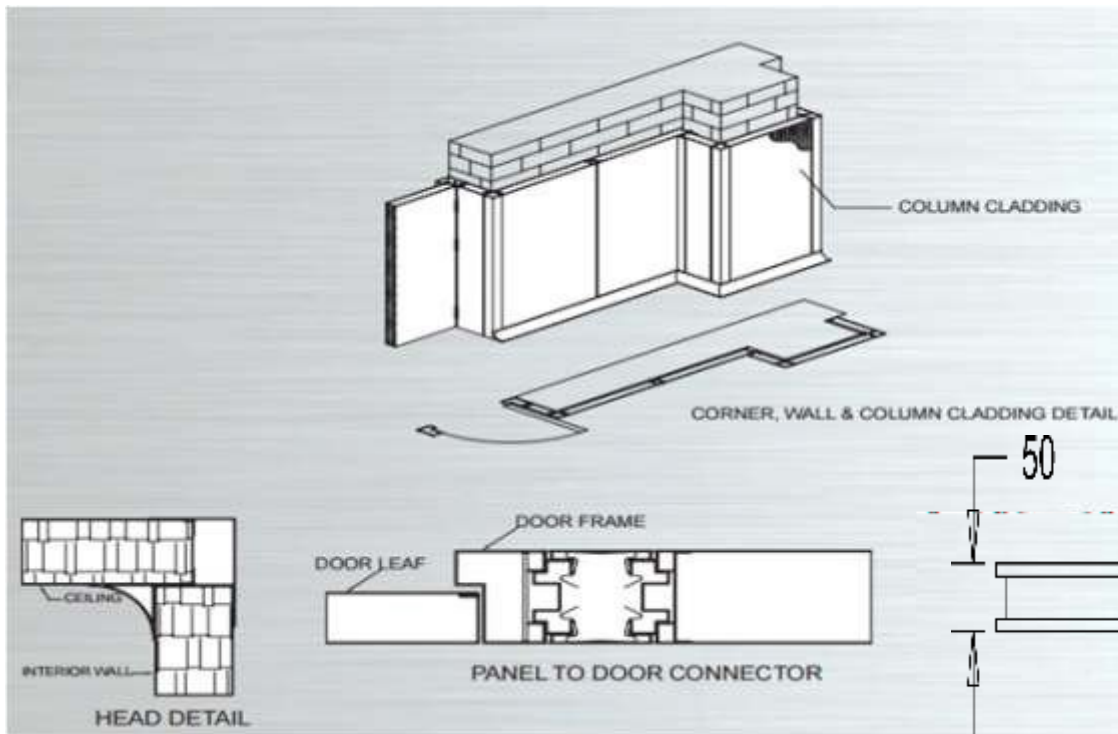

Technical Specifications

Product name	: Wall And ceiling panel
Product Code	: AMT 634
Thickness	: 30mm,50mm,60mm,80mm,100mm
Material in Fill	: rigid polyurethane or honey comb
Wall material	: SS-304,PPGI Aluminum , HPL, GPSP
Density	: 40 to 42 Kg/m3
Joint	: Male/Femal connector
Cut outs	: As per requirement
Paint	: pre paint/anti-bacterial

WALL AND CEILING PANEL AMT-



Technical specification:

- 1) Easy to install
- 2) Base Chanel with adjustment
- 3) Digitally Printed
- 4) Chemical resistive paint
- 5) Anti-Bacterial
- 6) Easy to clean
- 7) 8 mm toughened glass insulated with 50 mm puff
- 8) Fire retardant
- 9) Screech less
- 10) Print design can be selected form 1000000 of design
- 11) More life
- 12) High Elusion
- 13) High Toughness
- 14) Self withstanding power (need not any base structure for installation.)



A stainless steel double-compartment sink. The back panel features two faucets, one for each compartment. The front panel has two doors, each with a small handle. The sink is made of polished metal and is designed for commercial or institutional use.



Product Code	: AMT 626 (S1/S2/S3)
Product Name	: SS SCRUB SINK Single Bay
Finish	: Brush Finish
Material	: SS -304
Thickness	: 1.5 MM
Operator	: Full Automatic with foot operation manual with elbow operated
Packaging Type	: Wrapped Package /wooden packing with extra charge.
Operators	: One bay/two bay/ three bay
Type	: Standard ,Modular AMT-626(M1/M2/M3)

A stainless steel laboratory sink with a faucet and a digital display on the wall. The sink is rectangular and has a polished metal finish. The faucet is located on the left side of the sink. The digital display is mounted on the wall above the sink, showing a red digital readout. The sink is set into a countertop.

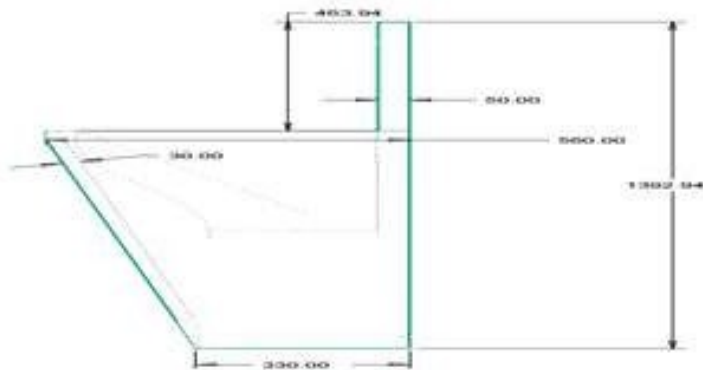

1. Seam less welded construction
2. Polished to satin hair line finished
3. Front excess plane
4. Water control valve
5. Had pre operation
6. Thermostatic mixing
7. Adjustable timing of water flow
8. Knee or foot operated

21

LAMINAR AIR FLOW

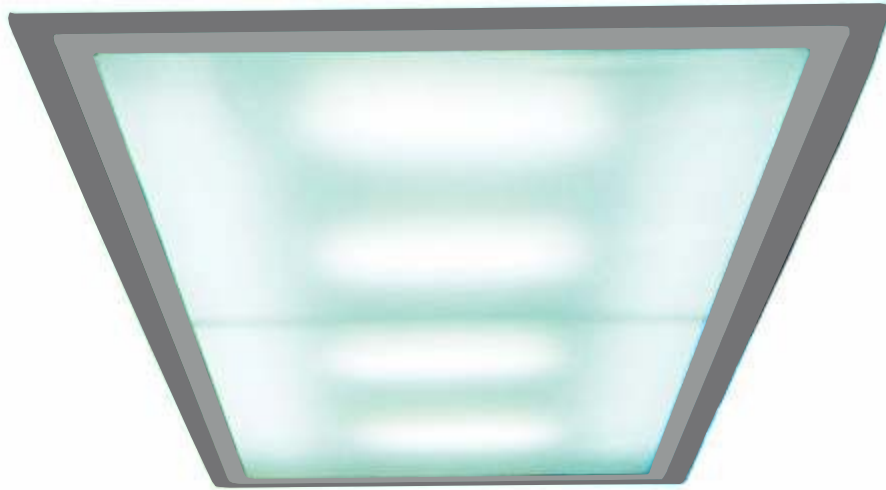

Product name	: Laminar Air Flow
Product Code	: AMT - 627
Product main Raw material	: Extruded aluminum profile, Sheet
Separator	: continuous thermo plastic chord
Gasket	: PVC or rubber
Final pressure drop	: 600 pa(max)
Maximum Operating Temp	: 60 degree Celsius
Maximum RH	: 40-50%
Size	: 2440mm x 2440mm /1800 x 1800,/ 2400 x 1800/ or customize
Filtration System	: HEPA filter
Diffusion System	: Diffuser cloth or perforated Grill

HATCH BOX (PASS BOX) STANDARD

Pass Boxes, are so designed to removed waste material from the operation theater to dirty linen area/crower just adjacent to operation theater

Feature:

Product Code : AMT -625 (S)

- 1 Automatic operated two doors
- 2 Material SS-304
- 3 One door can open at one time
- 4 Protected with UV light when both door are closed
- 5 CFL light on and UV light Off when any one door opens
- 6 Open / close states indicates on both side on display
- 7 Customize size
- 8 Microprocessor based controller

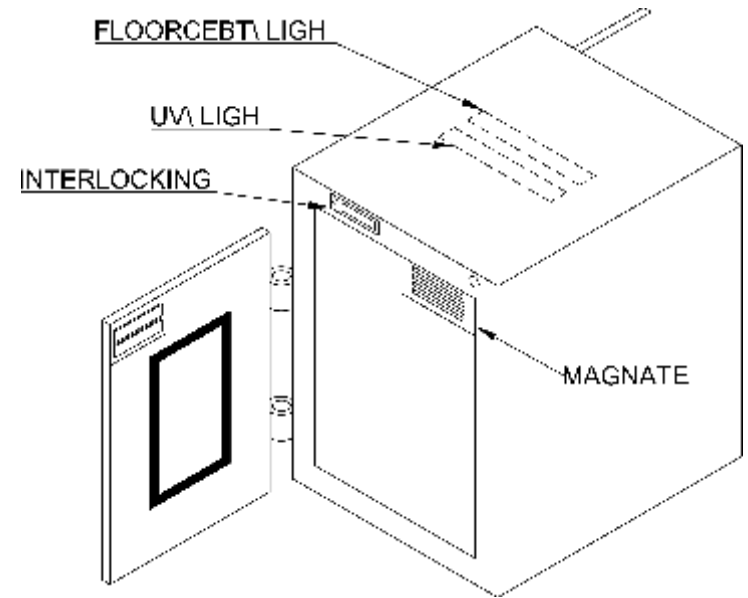

MODULAR HATCH BOX

Modular hatch box :

AMT – 625 (M) fabricated and manufactured with high class of material of SS -304 and welled all corner joints to make it as a single piece and reduces curve and junctions to make it highly cleanness



HERMETIC SEAL SWING DOOR



Installation Space:

The totality of the hermetic swing doors is designed to guarantee and ensure hermetic tightness. Guaranteed hygiene to materials such as stainless steel or high density laminate

Technical Specifications:

Product name	: Hermetic seal swing door
Product Code	: AMT -628
Product main Raw material	: stainless steel, high-density laminate/PPGI
Lock	: Cylindrical lock
Handle	: SS – 304
Thickness of Door	: 42mm to 60mm
Size of the Door	: Fully customizable sizes / One or double leaf.
Elegant design	: Flush view panel and easy cleaning.
Color	: As per requirement
Leaf thickness	: 42 to 60 mm
Frame thickness	: 50 to 100 mm
Infill	: Honeycomb or Puff
View panel	: Double glazed toughen glass of 5MM thickness in size of 300 x 300 mm/ 400 x 600 MM
Sealing Gasket	: PVC or rubber gasket to make leak proof

HERMETICALLY SEALED SLIDING DOOR (MANUAL SLIDING DOOR)



Installation Space: it provides an airtight sealed entrance for clean room type environments such as operating theatres, pharmaceutical production facilities, food preparation facilities and laboratories.

Technical Specifications

Product name	: Hermetic seal Sliding door
Product Code	: AMT- 629(M)
Lock	: cylindrical lock
Handle	: SS - 304
Thickness of Door	: 55mm to 60mm
Color	: As per requirement
View window	: 300 x 300mm , 400 x 400mm toughened glass of 5mm thickness
Clear opening	: 800 to 2500mm
Gasket	: synthetic Rubber/ PVC, Soft PVC Gasket
Color	: As per requirement
Frame material	: Aluminum Extruded profile
Door	: Aluminum Extruded profile with PPGI, HPL, SS
Infill	: Puff or Honeycomb
Sliding Mechanism	: High impactive rollers of nylon insert bearing system
Sliding system	: Aluminum Extruded profile with high smoothness.
Type	: Manual Sliding Door, Automatic Sliding Door



AUTOMATIC SLIDING DOOR

Operating rooms are responsible for performing surgery and rescuing critically ill patients, the working quality of which will directly affect postoperative recovery and medical result. Along with the improvement of medical conditions, the application of clean operating rooms has become more popular, and the equipment of clean operating rooms has become one of the important indicators of hospital construction. It plays a significant role in reducing exogenous surgical infection. Therefore, automatic Sliding doors that can meet higher and more special requirements are needed at the entrance of clean areas.

Technical Specifications

Product name	: Hermetic seal Sliding door
Product Code	: AMT- 629(A)
Lock	: cylindrical lock
Handle	: SS – 304
Thickness of Door	: 55mm to 60mm
Color	: As per requirement
Motor	: DC- Brush less motor
View window	: 300 x 300mm , 400 x 400mm loughen glass of 5mm thickness
Clear opening	: 800 to 2500mm
Gasket	: synthetic Rubber/ Pvc ,Soft PVC Gasket
Color	: As per requirement
Operation	: microprocessor based controller
Frame material	: Aluminum Extruded profile
Door	: Aluminum Extruded profile with PPGI, HPL,SS
Infill	: Puff or Honeycomb
Sliding Mechanism	: High impactive rollers of nylon insert bearing system
Sliding system	: Aluminum Extruded profile with high smoothness.
Type	: Manual Sliding Door , Automatic Sliding Door



CONTROL PANEL

TOUCH SCREEN AMT -631(T)

1. High contrasts, high luminance and with high strength outer box.
2. Using ultrasound touch panel, High density touch accuracy, more than 10,000 point per square inch.
3. Automatic adjustment, high response speed, reliability and stability without drift, more than 5 millions of times touch control in each point
4. Available fingers, soft pen, can be used even wet



TOUCH SCREEN CONTROL PANEL

SURGEON CONTROL PANEL

SURGEON CONTROL PANEL : AMT -631(S)

The following features are incorporated in the control panel:

1. Operation timing – Elapsed time
2. Anesthesia Countdown – Countdown timer
3. Time – Real time clock.
4. Date
5. Temperature and Humidity Display and control
6. Hands Free Telephone
7. Medical Gas Alarm System
8. Lighting Control – Peripheral Shadow less dome, Plenum light and View box with brightness control option
9. Negative Pressure Indication.

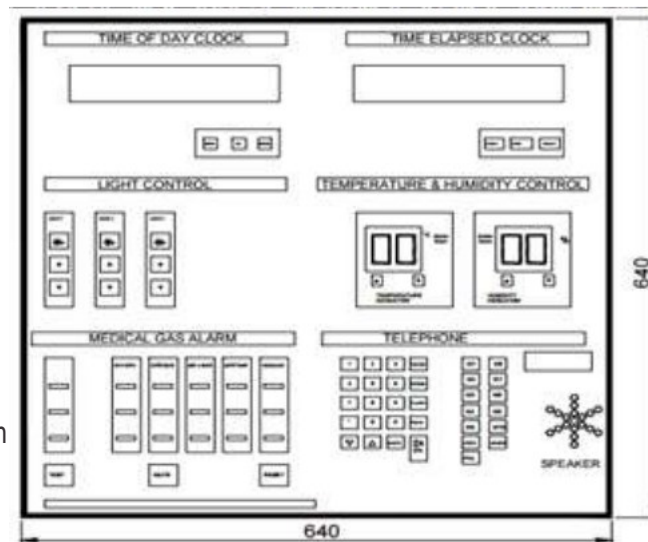

X-RAY BOARD AMT-

Specializes in the manufacture of X-ray film viewers (X-ray illuminator, X-Ray Film Viewer, LED X Ray Viewer, Slim LED View Box, X Ray View Boxes, X Ray Viewer, View Box). Keeping the needs of the doctors in mind along with the continuously changing demands of hospitals and Nursing homes, we have developed a sleek and effective L.E.D. Viewing system to view M.R.I, C.T. and X Ray images. Bio-X offers a range of Single Screen, Double Screen, Triple Screen, Quadruple Screen viewers.



Specifications:

Parameter		SINGLE SCREEN	DUAL SCREEN	TRIPLE SCREEN	QUADRUPLE SCREEN
Dimensions (mm)	Frame (L x H x T)	503 x 503 x 29 mm	880 x 503 x 29 mm	1255 x 503 x 29 mm	1631 x 503 x 29 mm
	Viewing Area (W x H)	360 x 440	736 x 440	1112 x 440	1488 x 440
Power Consumption		15W	30W	45W	60W
Light Source		LED	LED	LED	LED
Power Supply Input		AC100-240V 50/60Hz	AC100-240V 50/60Hz	AC100-240V 50/60Hz	AC100-240V 50/60Hz
Brightness (LUX)		>5,500	>5,500	>5,500	>5,500
Net Weight (Kgs)		4.8	8.8	12.4	16



WRITING BOARD : AMT-632

Product Description:

Owing to our extensive market experience, we are able to offer excellent quality

Writing Board.

Features:

- Enhanced visibility
- High resistance to cracks
- Longer service life

Other Details:

Owing to the dedication and efforts of our distinguished professionals, we have been able to provide Writing Board to our esteemed clients. We used optimum grade raw material to manufacture this product keeping in mind the exact specifications of the clients. It is tested on different parameters so that it can prove highly comfortable for writing. Owing to its brightness, the written words, digits and drawn pictures are clearly viewable on this board.

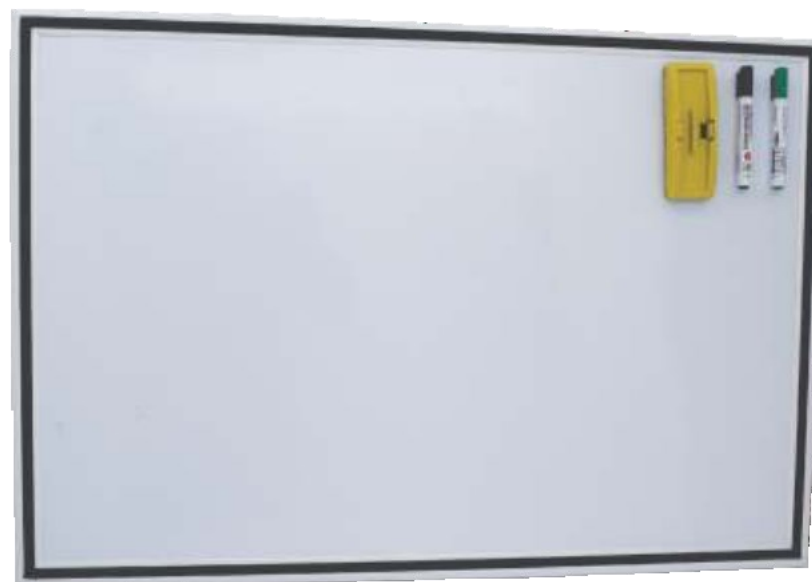

PERIPHERAL LIGHT AMT-

Keeping the needs of our customer in mind along with the continuously changing demands of hospitals, hotels, commercial and residential projects we have developed an effective LED Ceiling Light.

Properties

Led Life	: 50,000 Hours
Colour Rendering	: 90%
Efficiency	: 85%
Maximum Surface Luminance	: 3000 Lux
Wattage	: 24 Watts
Dimensions	: 585mm x 245mm



PRESSUR RELIFE DAMPERS: AMT-635

Operating theatres need to be protected from the ingress of airborne contamination to maintain the air in a clean and sterile condition. Suitably sized air pressure relief damper strategically placed, enable differential room pressures to be maintained and ensure that when doors are opened between clean and dirty areas there is sufficient air flow through the open door to prevent cross contamination.

Technical Specification

Product Name	: Pressure Relief Dampers
Product code	: AMT-635
Dimension	: Varies
Material	: Stainless steel Blade with stainless body
Air Movement	: Through opening On Pressure relief Dampers.



CURTAIN TRACK & SYSTEMS AMT-



Hospital Curtain Track System



This collection of curtain tracks with hardware is ideal for a wide variety of uses including draperies and cubicle curtains. These curtain tracks are designed for ceiling as well as wall mount and include rigid metal tracks as well as curved and flexible curtain tracks. These curtain tracks are perfect for home use, especially when hanging large heavy draperies and for high ceiling applications. Cubicle curtain tracks that are used in hospitals are offered as well as buttery smooth traversing drapery track used in hotels. Hardware for installing these curtain tracks is offered for variety of different applications



NURSE CALL SYSTEM AMT-643

- NURSE CALL SYSTEM
- It is designed with static windows and one can insert a bromide film (or similar thing) with the required letters to identify the room
- Voice module with standard voice attention and patient calling instead of buzzer makes it distinguished
- Can replace legacy buzzer system without having to re-lay the wires
- Very low working voltage to ensure patient's safety.
- Very simple design to make it easily installable and Maintenance free.
- Door indicator helps the nurses to locate the calling patient easily.
- Call from a patient remains registered till the nurse attends the patient and clears the call from his room.





Aishwariya Meditech Pvt Ltd

B-1231, iThum Tower, Plot N- A-40. Sector 62, Noida 201301 U.P. www.aishmed.com

- **DELHI**
- **BHOPAL**
- **BANGALORE**
- **KOLKATTA**